

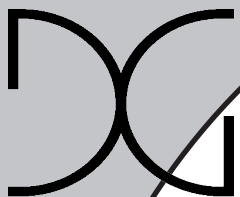

# TRIANGLE BOOTH DISPLAY WITH CUSTOM GRAPHICS

*Assembly Instructions*



## DISPLAYS2GO

CONNECTING PEOPLE & BRANDS WITH THE WORLD

# PARTS LIST

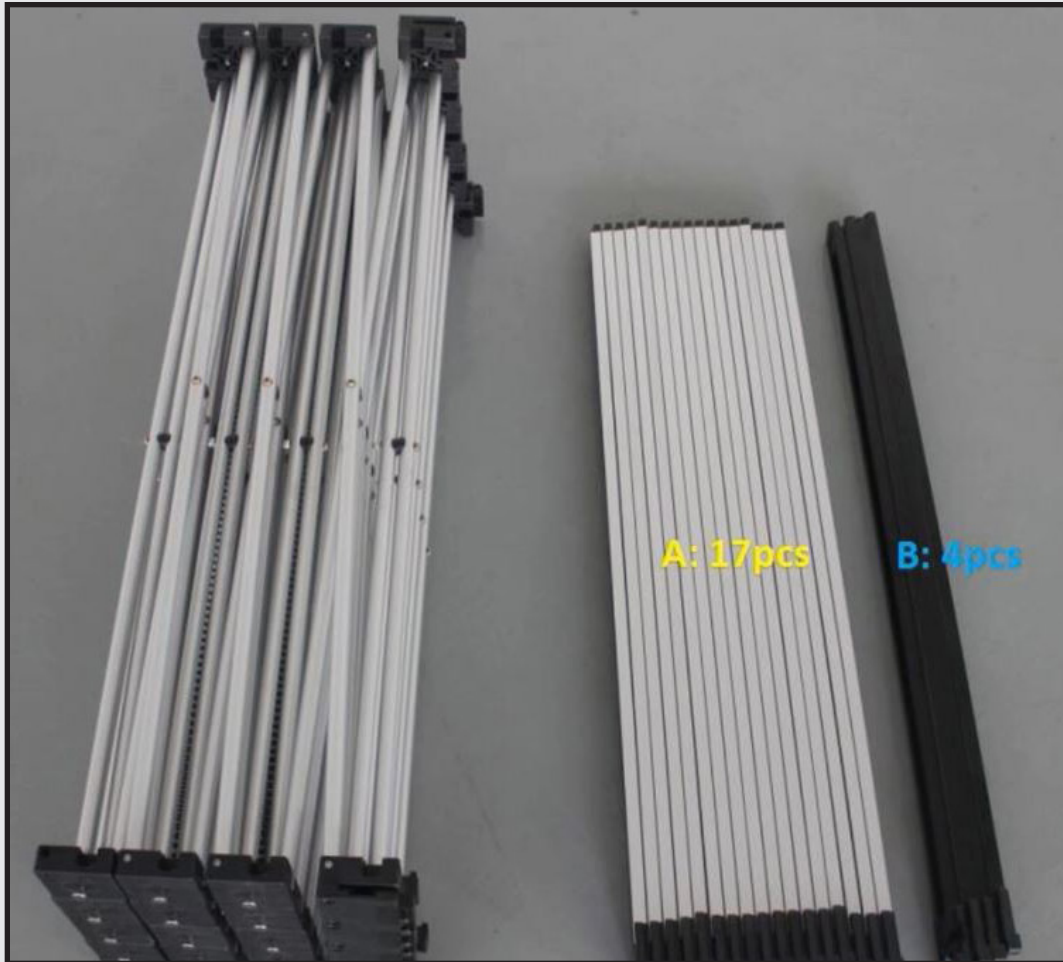

PART	QUANTITY
A: Extendable Frame .....	1
B: Support Poles.....	17
C: Base Pieces.....	4



Scan QR code to visit product page.  
Video of assembly available.

If you have any questions regarding our products, please visit us at [www.displays2go.com](http://www.displays2go.com) or contact D2G customer service at 844-221-3388.

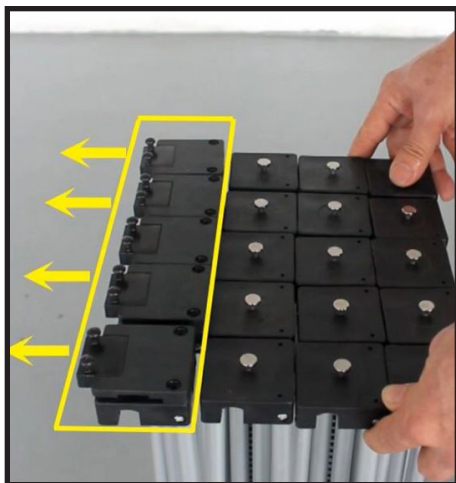

1. Pull extendable frame apart, then reach inside and expand upward. The frame will extend naturally as you pull it open.
2. Place frame on its edge, standing straight up.

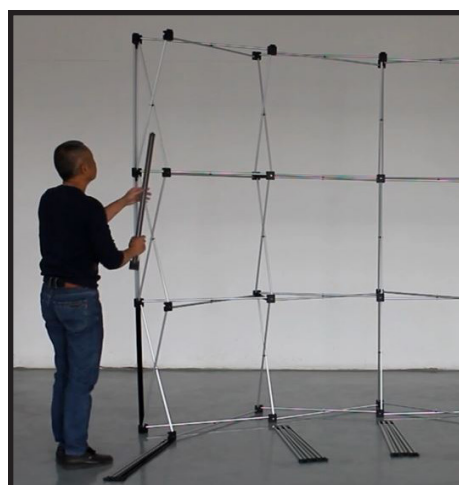
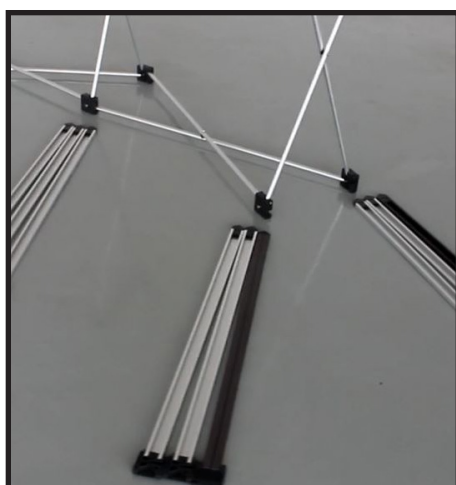

3. Place support poles and base pieces in groups of three at each point along the front of the unit. The base pieces will be part of the two edges of the frame, one per group with two support poles. Support poles will be in groups of three, as shown along the front of the frame.
4. Attach each piece to the frame by sliding the notch over the frame's corner points (see below).

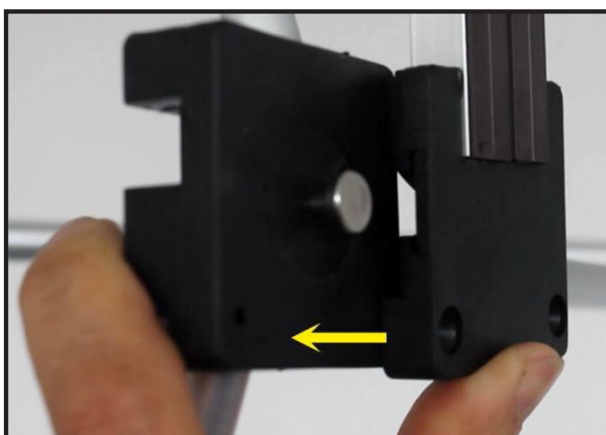

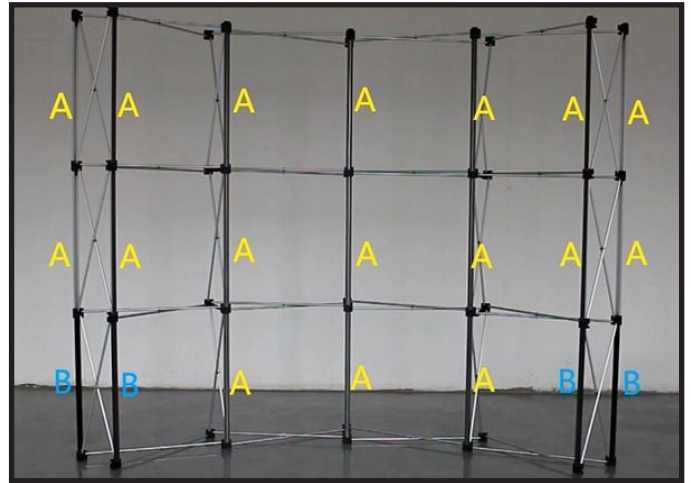

5. Continue to assemble the frame by snapping the support poles along the corner points of the front of the frame, as shown above.
6. Repeat steps 1-5 with the second and third frames.



7. Position frames with outside edges lined up. The frames should form a triangle shape once arranged properly. Be sure to align the corner points of each frame's edges, as shown above.



# ASSEMBLING SIGNAGE

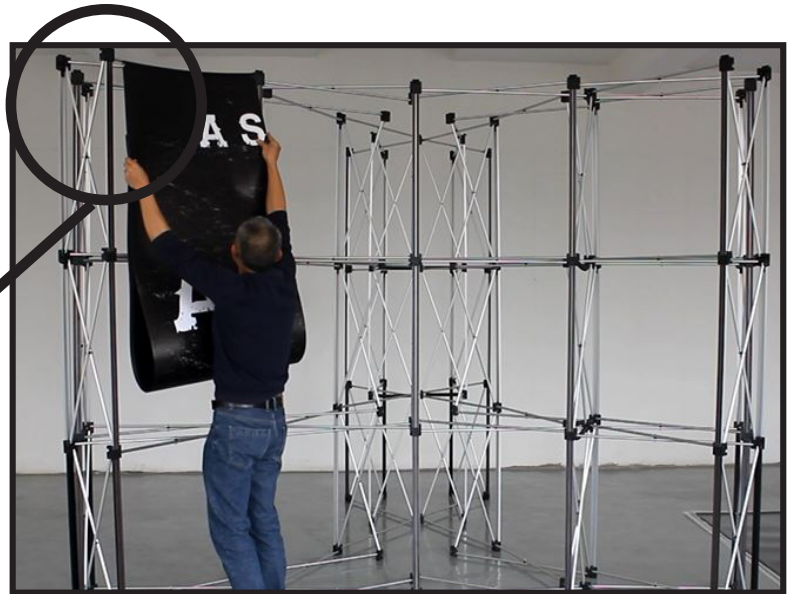
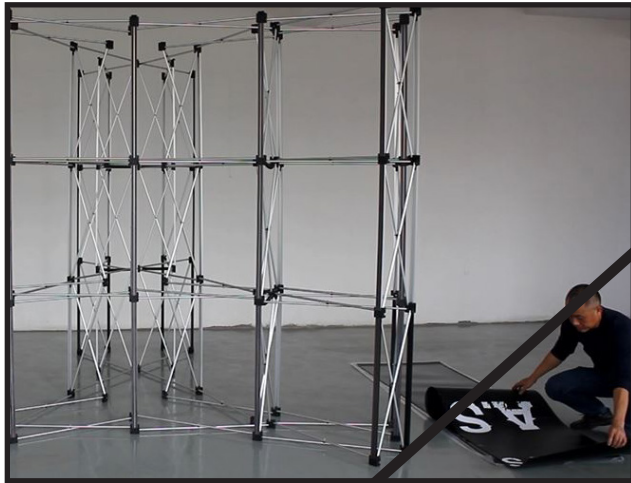

1. Carefully remove signage from its packaging. Take care not to drag the signage on the ground when transferring to the frame.
2. Hang signage from the frame by sliding the notches at the top onto the hook, as shown. The signage will secure to the frame magnetically to stay in place. Press gently along the edges of signage to move into place.
3. Repeat these steps for all the pieces of signage on each side of your unit.



4. Unroll one corner panel and secure to the unit in the same way. These will bubble away from unit slightly, as shown. Repeat for all three corners of the unit.